

Tri-County School Forest

320 Acres (240 district owned & 80 conservation easement)

*Established in
1969*

W12409
County Road O
Hancock, WI



County Rd O

5th Ln.

7th Ave.

Beechnut Ave.

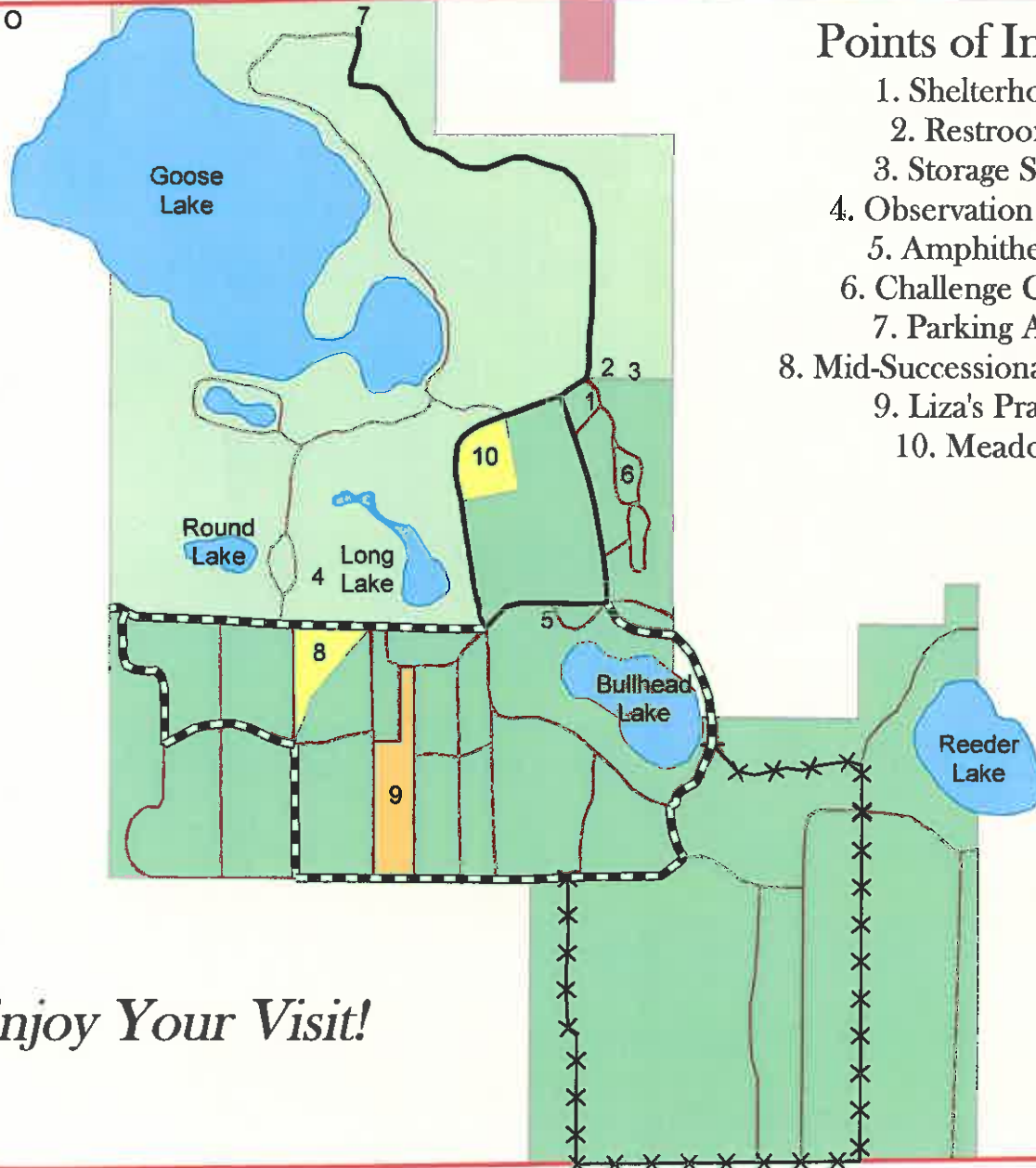

Points of Interest

1. Shelterhouse
2. Restrooms
3. Storage Shed
4. Observation Tower
5. Amphitheater
6. Challenge Course
7. Parking Area
8. Mid-Successional Meadow
9. Liza's Prairie
10. Meadow

- Timber View
- Whispering Pines
- ××× Plantation Trail
- Mixed Deciduous Forest
- Pine Plantation
- Private Structures
- Private Property

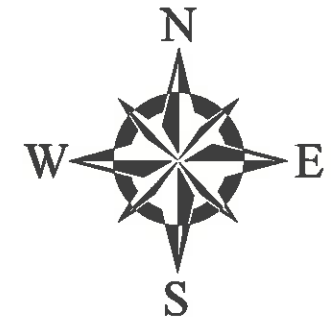

Enjoy Your Visit!

Tri-County Area
School District
409 South West Street
P.O. Box 67
Plainfield, WI 54966
715-335-6366

Tri-County School Forest Activity Trail System

This trail system was designed for your benefit. Whether hiking, biking, or skiing, we hope that you enjoy the beautiful landscape and gentle nature of the forest.

Three trails of various lengths have been developed. Each of the trails is an extension of the others, and each of the trails is marked with colored cross county skier arrows. Where trails intersect, trails are marked with two colored arrows. Feel free to take the trails of your choice and consider taking a copy of this map with you.

Timber View Trail (blue arrows)

Being the shortest trail, 1.5 miles, this trail serves as a good warmup and provides access to the other marked trails.

Whispering Pines Trail (green arrows)

An extension of timber view trail, this trail is a bit more challenging. At 2.65 miles, it offers gentle slopes and a beautiful view of Bullhead Lake.

Plantation Trail (red arrows)

The longest marked trail in the school forest, at 3.80 miles, the plantation trail is an extension of the whispering pines trail. This trail takes users to the south end of the property and offers additional distance and slopes to those enjoying the stands of pines along the path.

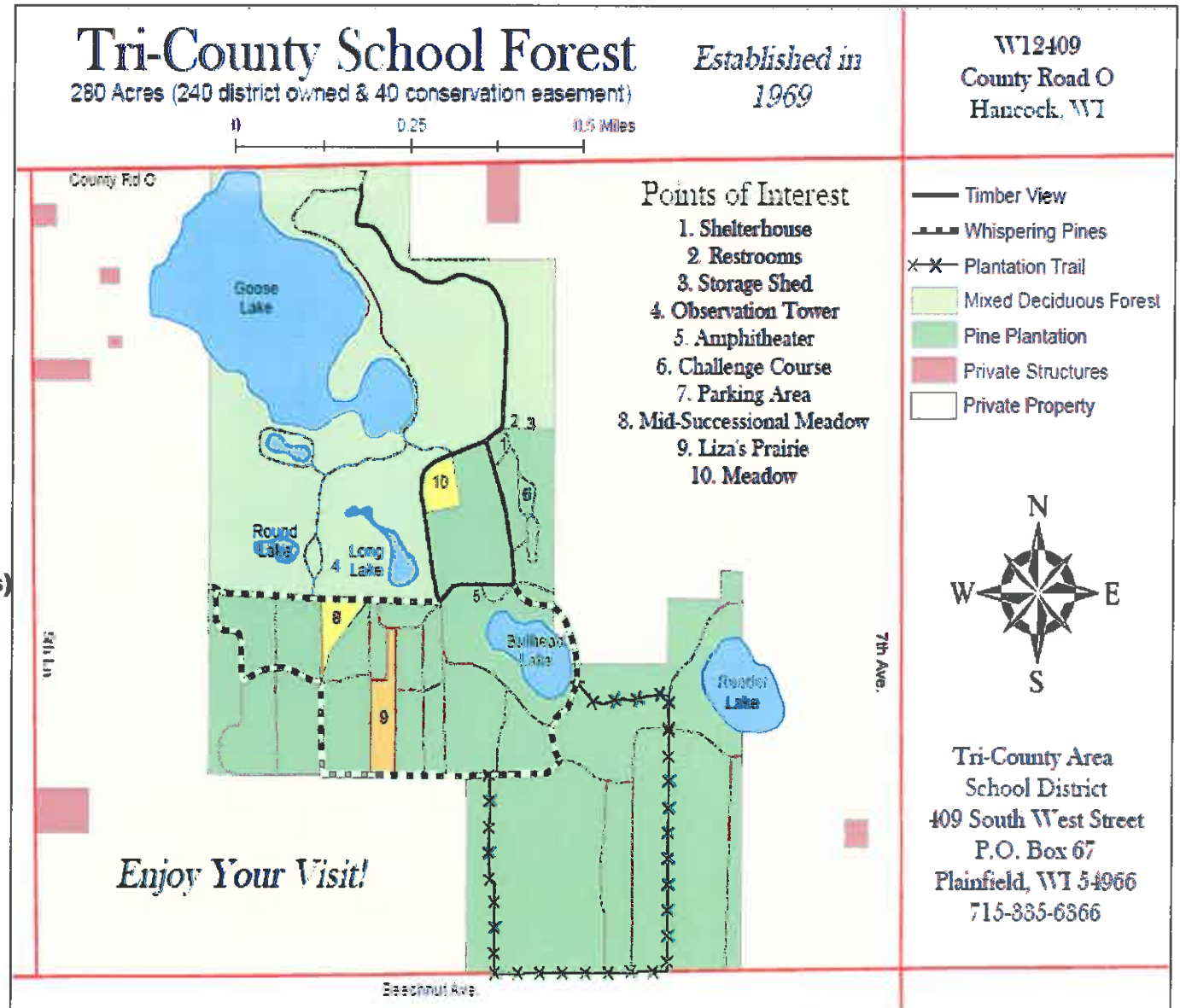



Tri-County School Forest Activity Trail System

Located between Hancock and
Plainfield, WI
on County Highway O



Tri-County Area School District
409 South West Street
P.O. Box 67
Plainfield, WI 54966
(715) 335-6366

